

# How to connect via Remote Desktop

- *Verify that you have permissions to connect to the desired computer*
- *If currently not connected to any BGU network, first connect via VPN*

1. Click on the Start Icon or press the Window key
2. Start typing "Remote "...
3. Finally click to open the app

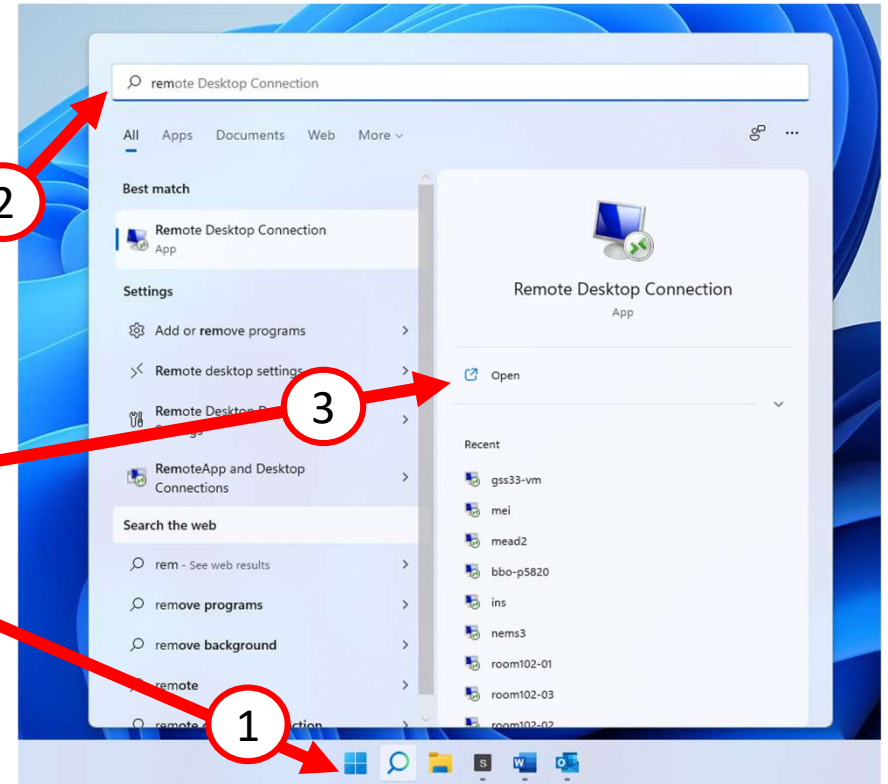

1. Type the ComputerName (computerName.auth.ad.bgu.ac.il when connected via VPN)
2. Click Connect

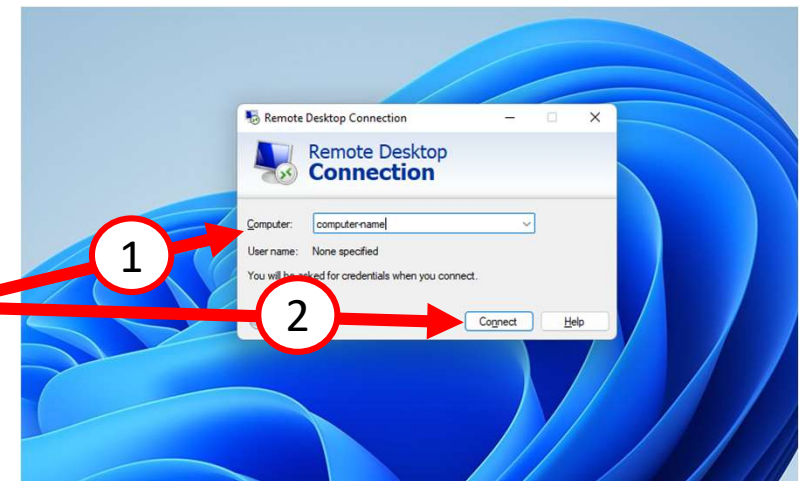

1. Type Organizational Username and Password  
notice the **bgu-users\** prefix
2. Click OK

